

Notice of variation and consolidation with introductory note

The Environmental Permitting (England & Wales) Regulations 2010

J & B Recycling Limited

Normanby Wharf
Dockside Road
Cargo Fleet
Middlesbrough
TS3 8AT

Variation application number

EPR/BB3107SC/V003

Permit number

EPR/BB3107SC

Normanby Wharf

Permit number EPR/BB3107SC

Introductory note

This introductory note does not form a part of the notice.

Under the Environmental Permitting (England & Wales) Regulations 2010 (schedule 5, part 1, paragraph 19) a variation may comprise a consolidated permit reflecting the variations and a notice specifying the variations included in that consolidated permit.

Schedule 1 of the notice specifies the conditions that have been varied and schedule 2 comprises a consolidated permit which reflects the variations being made. All the conditions of the permit have been varied and are subject to the right of appeal.

The variation EPR/BB3107SC/V003 updates the permit to modern conditions and adds the new activities of hazardous waste storage (liquid waste), waste wood storage and treatment, hazardous WEEE storage and non hazardous WEEE Storage and treatment. These changes have been issued as a consolidated permit that also updates all previous conditions to modern template conditions.

The status log of a permit sets out the permitting history, including any changes to the permit reference number.

Status log of the permit		
Description	Date	Comments
Waste Management Licence issued to Teeside Waste Management Ltd. (EAWML 66002)	9/6/1998	
Waste Management Licence Modified	04/12/2003	
Waste Management Licence transferred to Alab Environmental Services Limited	30/1/2007	
Waste Management Licence became an environmental permit (EPR no: EPR/CP3597LL)	06/04/2008	
Environmental Permit Transferred to J & B Recycling Limited (EPR/BB3701SC/T001)	24/02/2014	
Application EPR/BB3107SC/V002	Withdrawn 21/03/14	
Application EPR/BB3107SC/V003	Duly made 12/05/2014	Application for variation to include, hazardous waste storage and transfer, electronic equipment authorised treatment (excluding ozone-depleting substances) and wood storage and treatment facility.
Permit determined	03/07/2014	Permit issued to J & B Recycling Limited

End of introductory note

Notice of variation and consolidation

The Environmental Permitting (England and Wales) Regulations 2010

The Environment Agency in exercise of its powers under regulation 20 of the Environmental Permitting (England and Wales) Regulations 2010 varies and consolidates

permit number

EPR/BB3107SC

issued to

J & B Recycling Limited (“the operator”),
whose registered office is

Windermere MRF
Thomlinson Road
Hartlepool
TS25 1NS

company registration number 2905505

to operate a regulated facility at

Normanby Wharf,
Dockside Road,
Cargo Fleet,
Middlesbrough
TS3 8AT

to the extent set out in the schedules.

The notice shall take effect from 03/07/2014

Name	Date
Tracey Pollard	03/07/2014

Authorised on behalf of the Environment Agency

Schedule 1

All conditions have been varied by the consolidated permit as a result of the application made by the operator.

Schedule 2 – consolidated permit

Consolidated permit issued as a separate document.

Permit

The Environmental Permitting (England and Wales) Regulations 2010

Permit number

EPR/BB3107SC

The Environment Agency hereby authorises, under regulation 13 of the Environmental Permitting (England and Wales) Regulations 2010

J & B Recycling Limited (“the operator”),

whose registered office is

**Windermere MRF
Thomlinson Road
Hartlepool
TS25 1NS**

company registration number 2905505

to operate waste operations at

**Normanby Wharf,
Dockside Road,
Cargo Fleet,
Middlesbrough
TS3 8AT**

to the extent authorised by and subject to the conditions of this permit.

Name	Date
Tracey Pollard	03/07/2014

Authorised on behalf of the Environment Agency

Conditions

1 Management

1.1 General management

1.1.1 The operator shall manage and operate the activities:

- (a) in accordance with a written management system that identifies and minimises risks of pollution, including those arising from operations, maintenance, accidents, incidents, non-conformances, closures and those drawn to the attention of the operator as a result of complaints; and
- (b) using sufficient competent persons and resources.

1.1.2 Records demonstrating compliance with condition 1.1.1 shall be maintained.

1.1.3 Any person having duties that are or may be affected by the matters set out in this permit shall have convenient access to a copy of it kept at or near the place where those duties are carried out.

1.1.4 The operator shall comply with the requirements of an approved competence scheme.

1.2 Avoidance, recovery and disposal of wastes produced by the activities

1.2.1 The operator shall take appropriate measures to ensure that:

- (a) the waste hierarchy referred to in Article 4 of the Waste Framework Directive is applied to the generation of waste by the activities; and
- (b) any waste generated by the activities is treated in accordance with the waste hierarchy referred to in Article 4 of the Waste Framework Directive; and
- (c) where disposal is necessary, this is undertaken in a manner which minimises its impact on the environment.

1.2.2 The operator shall review and record at least every four years whether changes to those measures should be made and take any further appropriate measures identified by a review.

2 Operations

2.1 Permitted activities

2.1.1 The operator is only authorised to carry out the activities specified in schedule 1 table S1.1 (the "activities").

2.2 The site

2.2.1 The activities shall not extend beyond the site, being the land shown edged in green on the site plan at schedule 7 to this permit.

2.3 Operating techniques

- 2.3.1 (a) The activities shall, subject to the conditions of this permit, be operated using the techniques and in the manner described in the documentation specified in schedule 1, table S1.2 unless otherwise agreed in writing by the Environment Agency.
- (b) If notified by the Environment Agency that the activities are giving rise to pollution, the operator shall submit to the Environment Agency for approval within the period specified, a revision of any plan or other documentation (“plan”) specified in schedule 1, table S1.2 or otherwise required under this permit which identifies and minimises the risks of pollution relevant to that plan , and shall implement the approved revised plan in place of the original from the date of approval, unless otherwise agreed in writing by the Environment Agency.
- 2.3.2 Waste shall only be accepted if:
- (a) it is of a type and quantity listed in schedule 2 tables S2.1, S2.2, S2.3; and
- (b) it conforms to the description in the documentation supplied by the producer and holder.

2.4 Technical requirements

WEEE treatment

- 2.4.1 The storage (including temporary storage) and treatment of WEEE shall be carried out in accordance with the technical requirements of Annex VIII of the WEEE Directive.
- 2.4.2 WEEE shall be treated using best available treatment, recovery and recycling techniques (BATRRRT).
- 2.4.3 As a minimum, the substances, preparations and components specified in table 2.4 shall be removed from any separately collected WEEE.

Table 2.4 Substances, preparations and components to be removed from separately collected WEEE

- Capacitors containing Polychlorinated biphenyls (PCB)
- Mercury-containing components, such as switches or backlighting lamps
- Batteries
- Printed circuit boards of mobile phones generally, and of other devices if the surface of the printed circuit board is greater than 10 square centimetres
- Toner cartridges, liquid and pasty, as well as colour toner
- Plastic containing brominated flame retardants
- Asbestos waste and components which contain asbestos
- Cathode ray tubes
- Chlorofluorocarbons (CFC), hydrochlorofluorocarbons (HCFC), hydrofluorocarbons (HFC), or hydrocarbons (HC)
- Gas discharge lamps
- Liquid crystal displays (together with their casing where appropriate) of a surface greater than 100 square centimetres and all those back-lighted with gas discharge lamps
- External electric cables
- Components containing refractory ceramic fibres
- Components containing radioactive substances with the exception of components that are below the exemption thresholds set in Article 3 of and the Annex I to Council Directive 96/29/Euratom of 13 May 1996 laying down basic safety standards for the protection of the health of workers and the general public against the dangers arising from ionising radiation
- Electrolytic capacitors containing "substances of concern" (height > 25mm, diameter > 25 mm or proportionately similar volume)

2.4.4 All fluids contained within any WEEE shall be removed prior to further treatment.

2.4.5 Separately collected components of WEEE specified in table 2.3 shall be treated in accordance with the methods specified in that table.

Table 2.3 Specified Treatment Methods for separately collected components of WEEE

Component	Specified Treatment
Cathode ray tubes	The fluorescent coating shall be removed.
Gas discharge lamps	The mercury shall be removed.

2.4.6 Equipment shall be provided to record the weight of untreated WEEE accepted at, and components and materials leaving the site.

Hazardous waste storage and treatment

2.4.7 Hazardous waste shall not be mixed, either with a different category of hazardous waste or with other waste, substances or materials, unless it is authorised by schedule 1 table S1.1 and appropriate measures are taken.

3 Emissions and monitoring

3.1 Emissions to water, air or land

3.1.1 There shall be no point source emissions to water, air or land.

3.2 Emissions of substances not controlled by emission limits

- 3.2.1 Emissions of substances not controlled by emission limits (excluding odour) shall not cause pollution. The operator shall not be taken to have breached this condition if appropriate measures, including, but not limited to, those specified in any approved emissions management plan, have been taken to prevent or where that is not practicable, to minimise, those emissions.
- 3.2.2 The operator shall:
- (a) if notified by the Environment Agency that the activities are giving rise to pollution, submit to the Environment Agency for approval within the period specified, an emissions management plan which identifies and minimises the risks of pollution from emissions of substances not controlled by emission limits;
 - (b) implement the approved emissions management plan, from the date of approval, unless otherwise agreed in writing by the Environment Agency.
- 3.2.3 All liquids in containers, whose emission to water or land could cause pollution, shall be provided with secondary containment, unless the operator has used other appropriate measures to prevent or where that is not practicable, to minimise, leakage and spillage from the primary container.

3.3 Odour

- 3.3.1 Emissions from the activities shall be free from odour at levels likely to cause pollution outside the site, as perceived by an authorised officer of the Environment Agency, unless the operator has used appropriate measures, including, but not limited to, those specified in any approved odour management plan, to prevent or where that is not practicable to minimise the odour.
- 3.3.2 The operator shall:
- (a) if notified by the Environment Agency that the activities are giving rise to pollution outside the site due to odour, submit to the Environment Agency for approval within the period specified, an odour management plan which identifies and minimises the risks of pollution from odour;
 - (b) implement the approved odour management plan, from the date of approval, unless otherwise agreed in writing by the Environment Agency.

3.4 Noise and vibration

- 3.4.1 Emissions from the activities shall be free from noise and vibration at levels likely to cause pollution outside the site, as perceived by an authorised officer of the Environment Agency, unless the operator has used appropriate measures, including, but not limited to, those specified in any approved noise and vibration management plan to prevent or where that is not practicable to minimise the noise and vibration.
- 3.4.2 The operator shall:
- (a) if notified by the Environment Agency that the activities are giving rise to pollution outside the site due to noise and vibration, submit to the Environment Agency for approval within the period specified, a noise and vibration management plan which identifies and minimises the risks of pollution from noise and vibration;
 - (b) implement the approved noise and vibration management plan, from the date of approval, unless otherwise agreed in writing by the Environment Agency.

3.5 Pests

- 3.5.1 The activities shall not give rise to the presence of pests which are likely to cause pollution, hazard or annoyance outside the boundary of the site. The operator shall not be taken to have breached this condition if appropriate measures, including, but not limited to, those specified in any approved pests management plan, have been taken to prevent or where that is not practicable, to minimise the presence of pests on the site.
- 3.5.2 The operator shall:
- (a) if notified by the Environment Agency, submit to the Environment Agency for approval within the period specified, a pests management plan which identifies and minimises risks of pollution from pests;
 - (b) implement the pests management plan, from the date of approval, unless otherwise agreed in writing by the Environment Agency.

4 Information

4.1 Records

- 4.1.1 All records required to be made by this permit shall:
- (a) be legible;
 - (b) be made as soon as reasonably practicable;
 - (c) if amended, be amended in such a way that the original and any subsequent amendments remain legible, or are capable of retrieval; and
 - (d) be retained, unless otherwise agreed in writing by the Environment Agency, for at least 6 years from the date when the records were made, or in the case of the following records until permit surrender:
 - (i) off-site environmental effects; and
 - (ii) matters which affect the condition of the land and groundwater.
- 4.1.2 The operator shall keep on site all records, plans and the management system required to be maintained by this permit, unless otherwise agreed in writing by the Environment Agency.

4.2 Reporting

- 4.2.1 The operator shall send all reports and notifications required by the permit to the Environment Agency using the contact details supplied in writing by the Environment Agency.
- 4.2.2 Within one month of the end of each year, the operator shall submit to the Environment Agency using the form made available for the purpose, the information specified on the form relating to the site and the waste accepted and removed from it during the previous year.

4.3 Notifications

- 4.3.1 The Environment Agency shall be notified without delay following the detection of:
- (a) any malfunction, breakdown or failure of equipment or techniques, accident, or emission of a substance not controlled by an emission limit which has caused, is causing or may cause significant pollution;

- (b) the breach of a limit specified in the permit; or
 - (c) any significant adverse environmental effects.
- 4.3.2 Any information provided under condition 4.3.1 shall be confirmed by sending the information listed in schedule 5 to this permit within the time period specified in that schedule.
- 4.3.3 Where the Environment Agency has requested in writing that it shall be notified when the operator is to undertake monitoring and/or spot sampling, the operator shall inform the Environment Agency when the relevant monitoring and/or spot sampling is to take place. The operator shall provide this information to the Environment Agency at least 14 days before the date the monitoring is to be undertaken.
- 4.3.4 The Environment Agency shall be notified within 14 days of the occurrence of the following matters, except where such disclosure is prohibited by Stock Exchange rules:
- Where the operator is a registered company:
- (a) any change in the operator's trading name, registered name or registered office address; and
 - (b) any steps taken with a view to the operator going into administration, entering into a company voluntary arrangement or being wound up.
- Where the operator is a corporate body other than a registered company:
- (a) any change in the operator's name or address; and
 - (b) any steps taken with a view to the dissolution of the operator.
- In any other case:
- (a) the death of any of the named operators (where the operator consists of more than one named individual);
 - (b) any change in the operator's name(s) or address(es); and
 - (c) any steps taken with a view to the operator, or any one of them, going into bankruptcy, entering into a composition or arrangement with creditors, or, in the case of them being in a partnership, dissolving the partnership.
- 4.3.5 Where the operator proposes to make a change in the nature or functioning, or an extension of the activities, which may have consequences for the environment and the change is not otherwise the subject of an application for approval under the Regulations or this permit:
- (a) the Environment Agency shall be notified at least 14 days before making the change; and
 - (b) the notification shall contain a description of the proposed change in operation.

4.4 Interpretation

- 4.4.1 In this permit the expressions listed in schedule 6 shall have the meaning given in that schedule.
- 4.4.2 In this permit references to reports and notifications mean written reports and notifications, except where reference is made to notification being made "without delay", in which case it may be provided by telephone.

Schedule 1 - Operations

Table S1.1 Activities		
Activity Reference	Description of activities for waste operations	Limits of activities and waste types
A1 Hazardous and Non-Hazardous transfer station	D15: Storage pending any of the operations numbered D1 to D14 (excluding temporary storage, pending collection, on the site where it is produced)	Unless stored or treated outside as specified waste: a) all bulking, transfer or treatment of waste shall be carried out inside a building; b) all waste shall be stored in a building or within a secure container. c) all waste shall be stored and treated on an impermeable surface with sealed drainage system.
	R13: Storage of wastes pending any of the operations numbered R1 to R12 (excluding temporary storage, pending collection, on the site where it is produced)	Specified waste shall be stored and treated on hard standing or on an impermeable surface with sealed drainage system. All asbestos waste shall be double bagged and stored in sealed lockable skips. There shall be no treatment of asbestos waste. The maximum quantity of hazardous waste and waste oils (in aggregate) that can be accepted or stored at the site shall not exceed 10 tonnes per day.
	D14: Repackaging prior to submission to any of the operations numbered D1 to 13	No more than 10 tonnes per day of hazardous waste to be treated at the site under a D14 activity.
	D9: Physico-chemical treatment not specified elsewhere which results in final compounds or mixtures which are disposed of by any of the operations numbered D01 to D12	Wastes shall be stored for no longer than 1 year prior to disposal or 3 years prior to recovery. Treatment consisting only of manual sorting, separation, screening, baling, shredding, crushing or compaction of waste into different components for disposal, (no more than 50 tonnes per day) or recovery.
	R3: Recycling/reclamation of organic substances which are not used as solvents	No more than a total of 50 tonnes of intact and shredded waste vehicle tyres (waste codes 16 01 03 and 19 12 04) shall be stored at the site.
	R4: Recycling/reclamation of metals and metal compounds	Waste types as specified in Table S2.1
A2 Waste electrical and electronic equipment authorised treatment facility	R5: Recycling/reclamation of other inorganic materials	
	R13: Storage of waste pending any of the operations numbered R1 to R12 (excluding temporary storage, pending collection, on the site where it is produced)	Treatment operations shall be limited to: Physical treatment including manual and mechanical sorting/ separation, screening, crushing, baling of non-hazardous waste for disposal (no more than 50 tonnes per day) or recovery. Except for WEEE awaiting manual dismantling, repair or refurbishment only the maximum quantity of hazardous waste that can be stored at the site shall not exceed 10 tonnes at any one time.
	D15: Storage pending any of the operations numbered D 1 to D 14 (excluding temporary storage, pending collection,	Wastes shall be stored for no longer than 1 year prior to disposal or 3 years prior to recovery.

Table S1.1 Activities

Activity Reference	Description of activities for waste operations	Limits of activities and waste types
	<p>on the site where the waste is produced)</p> <p>R3: Recycling/ reclamation of organic substances which are not used as solvents</p> <p>R4: Recycling/ reclamation of metals and metal compounds</p> <p>R5: Recycling/ reclamation of other inorganic compounds</p>	<p>Buildings, covered areas or containers shall meet the following requirements:</p> <ul style="list-style-type: none"> • buildings, covered areas, or containers shall be designed, constructed and maintained to prevent ingress of rain and surface water; • rain and uncontaminated surface water shall be kept separate from contaminated water and other liquids; • containers shall be stored on an impermeable surface with sealed drainage system. <p>Treatment of WEEE:</p> <ul style="list-style-type: none"> • shall be carried out within a building provided with a weatherproof covering; • shall be carried out on an impermeable surface with sealed drainage system with provision of spillage collection facilities and, where appropriate, decanters and cleanser degreasers; • there shall be no treatment of fridges. <p>Storage:</p> <ul style="list-style-type: none"> • WEEE, disassembled spare parts, components or residues shall be stored on an impermeable surface with sealed drainage system with provision of spillage collection facilities and, where appropriate, decanters and cleanser degreasers; • WEEE, disassembled spare parts, components or residues shall be stored in areas provided with a weatherproof covering where appropriate or in containers providing a weatherproof covering where appropriate; • disassembled spare parts containing liquids shall be stored in appropriate containers; • batteries, PCBs/PCTs containing capacitors and other hazardous wastes must be stored in dedicated, labelled and appropriate containers.
A3 Wood storage and treatment	<p>R13: Storage of wastes pending the operation numbered R3.</p> <p>R3: Recycling or reclamation of organic substances which are not used as solvents.</p>	<p>Waste types as specified in Table S2.2</p> <ul style="list-style-type: none"> • Treatment of wood wastes listed in table S2.3 consisting only of sorting, separation, cutting, pulverising, shredding, and chipping for recovery. • Secure storage of wastes listed in table 2.3 at the place where it is to be treated. • No wood waste shall be stored for more than 3 months. • No composting activity to take place on site. • Waste types as specified in Table S2.3

Table S1.2 Operating techniques

Description	Parts	Date Received
Application	Sections 3a– Technical Standards , Part B4 of the application form _ How To Comply	09/04/2014
Application	Section 3c - Questions for specific sectors, Part B4 of the application form_ SGN 5.06, Guidance on the recovery and disposal of hazardous and non- hazardous waste.	09/04/2014

Schedule 2 - Waste types, raw materials and fuels

Table S2.1 Permitted waste types and quantities for activity A1 - hazardous and non-hazardous waste for transfer, (excluding WEEE and waste wood transfer and treatment)

Maximum Quantities

The total quantity of all waste accepted at the site shall not exceed 1,000,000 tonnes per year

Waste code	Description
01	WASTES RESULTING FROM EXPLORATION, MINING, QUARRYING, AND PHYSICAL AND CHEMICAL TREATMENT OF MINERALS
01 01	wastes from mineral excavation
01 01 01	wastes from mineral metalliferous excavation
01 01 02	wastes from mineral non-metalliferous excavation
01 03	wastes from physical and chemical processing of metalliferous minerals
01 03 06	tailings other than those mentioned in 01 03 04 and 01 03 05
01 03 09	red mud from alumina production other than the wastes mentioned in 01 03 07
01 04	wastes from physical and chemical processing of non-metalliferous minerals
01 04 08	waste gravel and crushed rocks other than those mentioned in 01 04 07
01 04 09	waste sand and clays
01 04 11	wastes from potash and rock salt processing other than those mentioned in 01 04 07
01 04 12	tailings and other wastes from washing and cleaning of minerals other than those mentioned in 01 04 07 and 01 04 11
01 04 13	wastes from stone cutting and sawing other than those mentioned in 01 04 07
02	WASTES FROM AGRICULTURE, HORTICULTURE, AQUACULTURE, FORESTRY, HUNTING AND FISHING, FOOD PREPARATION AND PROCESSING
02 01	wastes from agriculture, horticulture, aquaculture, forestry, hunting and fishing
02 01 01	sludges from washing and cleaning
02 01 04	waste plastics (except packaging)
02 01 07	wastes from forestry
02 01 10	waste metal
02 02	wastes from the preparation and processing of meat, fish and other foods of animal origin
02 02 01	sludges from washing and cleaning
02 02 03	materials unsuitable for consumption or processing
02 03	wastes from fruit, vegetables, cereals, edible oils, cocoa, coffee, tea and tobacco preparation and processing; conserve production; yeast and yeast extract production, molasses preparation and fermentation
02 03 04	materials unsuitable for consumption or processing
02 04	wastes from sugar processing
02 04 01	soil from cleaning and washing beet
02 04 02	off-specification calcium carbonate

Table S2.1 Permitted waste types and quantities for activity A1 - hazardous and non-hazardous waste for transfer, (excluding WEEE and waste wood transfer and treatment)

Maximum Quantities

The total quantity of all waste accepted at the site shall not exceed 1,000,000 tonnes per year

Waste code	Description
02 05	wastes from the dairy products industry
02 05 01	materials unsuitable for consumption or processing
02 06	wastes from the baking and confectionery industry
02 06 01	materials unsuitable for consumption or processing
02 06 02	wastes from preserving agents
02 07	wastes from the production of alcoholic and non-alcoholic beverages (except coffee, tea and cocoa)
02 07 01	wastes from washing, cleaning and mechanical reduction of raw materials
02 07 02	wastes from spirits distillation
02 07 04	materials unsuitable for consumption or processing
03	WASTES FROM WOOD PROCESSING AND THE PRODUCTION OF PANELS AND FURNITURE, PULP, PAPER AND CARDBOARD
03 03	wastes from pulp, paper and cardboard production and processing
03 03 01	waste bark and wood
03 03 07	mechanically separated rejects from pulping of waste paper and cardboard
03 03 08	wastes from sorting of paper and cardboard destined for recycling
03 03 10	fibre rejects, fibre-, filler- and coating-sludges from mechanical separation
04	WASTES FROM THE LEATHER, FUR AND TEXTILE INDUSTRIES
04 01	wastes from the leather and fur industry
04 01 08	waste tanned leather (blue sheetings, shavings, cuttings, buffing dust) containing chromium
04 01 09	wastes from dressing and finishing
04 02	wastes from the textile industry
04 02 21	wastes from unprocessed textile fibres
04 02 22	wastes from processed textile fibres
06	WASTES FROM INORGANIC CHEMICAL PROCESSES
06 09	wastes from the MSFU of phosphorous chemicals and phosphorous chemical processes
06 09 02	phosphorous slag
06 09 04	calcium-based reaction wastes other than those mentioned in 06 09 03
06 11	wastes from the manufacture of inorganic pigments and opacifiers
06 11 01	calcium-based reaction wastes from titanium dioxide production
07	WASTES FROM ORGANIC CHEMICAL PROCESSES
07 02	wastes from the MFSU of plastics, synthetic rubber and man-made fibres
07 02 13	waste plastic

Table S2.1 Permitted waste types and quantities for activity A1 - hazardous and non-hazardous waste for transfer, (excluding WEEE and waste wood transfer and treatment)

Maximum Quantities

The total quantity of all waste accepted at the site shall not exceed 1,000,000 tonnes per year

Waste code	Description
08	WASTES FROM THE MANUFACTURE, FORMULATION, SUPPLY AND USE (MFSU) OF COATINGS (PAINTS, VARNISHES AND VITREOUS ENAMELS), ADHESIVES, SEALANTS AND PRINTING INKS
08 01	wastes from MFSU and removal of paint and varnish
08 01 11*	waste paint and varnish containing organic solvents or other dangerous substances
08 01 12	waste paint and varnish other than those mentioned in 08 01 11
09	WASTES FROM THE PHOTOGRAPHIC INDUSTRY
09 01	wastes from the photographic industry
09 01 07	photographic film and paper containing silver or silver compounds
09 01 08	photographic film and paper free of silver or silver compounds
09 01 10	single-use cameras without batteries
09 01 12	single-use cameras containing batteries other than those mentioned in 09 01 11
10	WASTES FROM THERMAL PROCESSES
10 01	wastes from power stations and other combustion plants (except 19)
10 01 01	bottom ash, slag and boiler dust (excluding boiler dust mentioned in 10 01 04)
10 01 05	calcium-based reaction wastes from flue-gas desulphurisation in solid form
10 01 07	calcium-based reaction wastes from flue-gas desulphurisation in sludge form
10 01 15	bottom ash, slag and boiler dust from co-incineration other than those mentioned in 10 01 14
10 01 19	wastes from gas cleaning other than those mentioned in 10 01 05, 10 01 07 and 10 01 18
10 01 24	sands from fluidised beds
10 02	wastes from the iron and steel industry
10 02 01	wastes from the processing of slag
10 02 02	unprocessed slag
10 02 08	solid wastes from gas treatment other than those mentioned in 10 02 07
10 02 10	mill scales
10 02 14	filter cakes from gas treatment other than those mentioned in 10 02 13
10 02 15	other sludges and filter cakes
10 03	wastes from aluminium thermal metallurgy
10 03 02	anode scraps
10 03 05	waste alumina
10 03 16	skimmings other than those mentioned in 10 03 15
10 03 18	carbon-containing wastes from anode manufacture other than those mentioned in 10 03 17
10 03 24	solid wastes from gas treatment other than those mentioned in 10 03 23
10 03 26	filter cakes from gas treatment other than those mentioned in 10 03 25

Table S2.1 Permitted waste types and quantities for activity A1 - hazardous and non-hazardous waste for transfer, (excluding WEEE and waste wood transfer and treatment)

Maximum Quantities

The total quantity of all waste accepted at the site shall not exceed 1,000,000 tonnes per year

Waste code	Description
10 03 28	wastes from cooling-water treatment other than those mentioned in 10 03 27
10 03 30	wastes from treatment of salt slags and black drosses other than those mentioned in 10 03 29
10 04	wastes from lead thermal metallurgy
10 04 10	wastes from cooling-water treatment other than those mentioned in 10 04 09
10 05	wastes from zinc thermal metallurgy
10 05 01	slags from primary and secondary production
10 05 09	wastes from cooling-water treatment other than those mentioned in 10 05 08
10 05 11	dross and skimmings other than those mentioned in 10 05 10
10 06	wastes from copper thermal metallurgy
10 06 01	slags from primary and secondary production
10 06 02	dross and skimmings from primary and secondary production
10 06 10	wastes from cooling-water treatment other than those mentioned in 10 06 09
10 07	wastes from silver, gold and platinum thermal metallurgy
10 07 01	slags from primary and secondary production
10 07 02	dross and skimmings from primary and secondary production
10 07 03	solid wastes from gas treatment
10 07 05	filter cakes from gas treatment
10 07 08	wastes from cooling-water treatment other than those mentioned in 10 07 07
10 08	wastes from other non-ferrous thermal metallurgy
10 08 09	other slags
10 08 11	dross and skimmings other than those mentioned in 10 08 10
10 08 13	carbon-containing wastes from anode manufacture other than those mentioned in 10 08 12
10 08 14	anode scrap
10 08 18	filter cakes from flue-gas treatment other than those mentioned in 10 08 17
10 08 20	wastes from cooling-water treatment other than those mentioned in 10 08 19
10 09	wastes from casting of ferrous pieces
10 09 03	furnace slag
10 09 06	casting cores and moulds which have not undergone pouring other than those mentioned in 10 09 05
10 09 08	casting cores and moulds which have undergone pouring other than those mentioned in 10 09 07
10 09 14	waste binders other than those mentioned in 10 09 13
10 09 16	waste crack-indicating agent other than those mentioned in 10 09 15
10 10	wastes from casting of non-ferrous pieces
10 10 03	furnace slag

Table S2.1 Permitted waste types and quantities for activity A1 - hazardous and non-hazardous waste for transfer, (excluding WEEE and waste wood transfer and treatment)

Maximum Quantities

The total quantity of all waste accepted at the site shall not exceed 1,000,000 tonnes per year

Waste code	Description
10 10 06	casting cores and moulds which have not undergone pouring, other than those mentioned in 10 10 05
10 10 08	casting cores and moulds which have undergone pouring, other than those mentioned in 10 10 07
10 10 14	waste binders other than those mentioned in 10 10 13
10 10 16	waste crack-indicating agent other than those mentioned in 10 10 15
10 11	wastes from manufacture of glass and glass products
10 11 03	waste glass-based fibrous materials
10 11 10	waste preparation mixture before thermal processing, other than those mentioned in 10 11 09
10 11 12	waste glass other than those mentioned in 10 11 11
10 11 16	solid wastes from flue-gas treatment other than those mentioned in 10 11 15
10 11 18	filter cakes from flue-gas treatment other than those mentioned in 10 11 17
10 12	wastes from manufacture of ceramic goods, bricks, tiles and construction products
10 12 01	waste preparation mixture before thermal processing
10 12 05	filter cakes from gas treatment
10 12 06	discarded moulds
10 12 08	waste ceramics, bricks, tiles and construction products (after thermal processing)
10 12 10	solid wastes from gas treatment other than those mentioned in 10 12 09
10 12 12	wastes from glazing other than those mentioned in 10 12 11
10 13	wastes from manufacture of cement, lime and plaster and articles and products made from them
10 13 01	waste preparation mixture before thermal processing
10 13 04	Waste from calcinations and hydration of lime
10 13 07	filter cakes from gas treatment
10 13 10	wastes from asbestos-cement manufacture other than those mentioned in 10 13 09
10 13 11	wastes from cement-based composite materials other than those mentioned in 10 13 09 and 10 13 10
10 13 13	solid wastes from gas treatment other than those mentioned in 10 13 12
10 13 14	waste concrete and concrete sludge
11	WASTES FROM CHEMICAL SURFACE TREATMENT AND COATING OF METALS AND OTHER MATERIALS; NON-FERROUS HYDRO-METALLURGY
11 01	wastes from chemical surface treatment and coating of metals and other materials (for example galvanic processes, zinc coating processes, pickling processes, etching, phosphatising, alkaline degreasing, anodising)
11 01 10	filter cakes other than those mentioned in 11 01 09
11 01 14	degreasing wastes other than those mentioned in 11 01 13

Table S2.1 Permitted waste types and quantities for activity A1 - hazardous and non-hazardous waste for transfer, (excluding WEEE and waste wood transfer and treatment)

Maximum Quantities

The total quantity of all waste accepted at the site shall not exceed 1,000,000 tonnes per year

Waste code	Description
11 02	wastes from non-ferrous hydrometallurgical processes
11 02 03	wastes from the production of anodes for aqueous electrolytical processes
11 02 06	wastes from copper hydrometallurgical processes other than those mentioned in 11 02 05
11 05	wastes from hot galvanising processes
11 05 01	hard zinc
11 05 02	zinc ash
12	WASTES FROM SHAPING AND PHYSICAL AND MECHANICAL SURFACE TREATMENT OF METALS AND PLASTICS
12 01	wastes from shaping and physical and mechanical surface treatment of metals and plastics
12 01 01	ferrous metal filings and turnings
12 01 03	non-ferrous metal filings and turnings
12 01 05	plastics shavings and turnings
12 01 13	welding wastes
12 01 17	waste blasting material other than those mentioned in 12 01 16
12 01 21	spent grinding bodies and grinding materials other than those mentioned in 12 01 20
15	WASTE PACKAGING; ABSORBENTS, WIPING CLOTHS, FILTER MATERIALS AND PROTECTIVE CLOTHING NOT OTHERWISE SPECIFIED
15 01	packaging (including separately collected municipal packaging waste)
15 01 01	paper and cardboard packaging
15 01 02	plastic packaging
15 01 03	wooden packaging
15 01 04	metallic packaging
15 01 05	composite packaging
15 01 06	mixed packaging
15 01 07	glass packaging
15 01 09	textile packaging
15 02	absorbents, filter materials, wiping cloths and protective clothing
15 02 03	absorbents, filter materials, wiping cloths and protective clothing other than those mentioned in 15 02 02
16	WASTES NOT OTHERWISE SPECIFIED IN THE LIST
16 01	End-of-life vehicles from different means of transporting (including off road machinery) and wastes from dismantling of end-of-life vehicles and vehicle maintenance (except 13,14,16 06 and 16 08).
16 01 03	end of life tyres

Table S2.1 Permitted waste types and quantities for activity A1 - hazardous and non-hazardous waste for transfer, (excluding WEEE and waste wood transfer and treatment)

Maximum Quantities

The total quantity of all waste accepted at the site shall not exceed 1,000,000 tonnes per year

Waste code	Description
16 03	off-specification batches and unused products
16 03 04	inorganic wastes other than those mentioned in 16 03 03
16 03 06	organic wastes other than those mentioned in 16 03 05
16 11	waste linings and refractories
16 11 02	carbon-based linings and refractories from metallurgical processes others than those mentioned in 16 11 01
16 11 04	other linings and refractories from metallurgical processes other than those mentioned in 16 11 03
16 11 06	linings and refractories from non-metallurgical processes others than those mentioned in 16 11 05
17	CONSTRUCTION AND DEMOLITION WASTES (INCLUDING EXCAVATED SOIL FROM CONTAMINATED SITES)
17 01	concrete, bricks, tiles and ceramics
17 01 01	concrete
17 01 02	bricks
17 01 03	tiles and ceramics
17 01 07	mixtures of concrete, bricks, tiles and ceramics other than those mentioned in 17 01 06
17 02	wood, glass and plastic
17 02 02	glass
17 02 03	plastic
17 03	bituminous mixtures, coal tar and tarred products
17 03 02	bituminous mixtures other than those mentioned in 17 03 01
17 04	metals (including their alloys)
17 04 01	copper, bronze, brass
17 04 02	aluminium
17 04 03	lead
17 04 04	zinc
17 04 05	iron and steel
17 04 06	tin
17 04 07	mixed metals
17 04 11	cables other than those mentioned in 17 04 10
17 05	soil (including excavated soil from contaminated sites), stones and dredging spoil
17 05 04	soil and stones other than those mentioned in 17 05 03
17 05 08	track ballast other than those mentioned in 17 05 07
17 06	insulation materials and asbestos-containing construction materials
17 06 01*	insulation materials containing asbestos

Table S2.1 Permitted waste types and quantities for activity A1 - hazardous and non-hazardous waste for transfer, (excluding WEEE and waste wood transfer and treatment)

Maximum Quantities

The total quantity of all waste accepted at the site shall not exceed 1,000,000 tonnes per year

Waste code	Description
17 06 04	insulation materials other than those mentioned in 17 06 01 and 17 06 03
17 06 05*	construction materials containing asbestos
17 08	gypsum-based construction material
17 08 02	gypsum-based construction materials other than those mentioned in 17 08 01
17 09	other construction and demolition wastes
17 09 04	mixed construction and demolition wastes other than those mentioned in 17 09 01, 17 09 02 and 17 09 03
19	WASTES FROM WASTE MANAGEMENT FACILITIES, OFF-SITE WASTE WATER TREATMENT PLANTS AND THE PREPARATION OF WATER INTENDED FOR HUMAN CONSUMPTION AND WATER FOR INDUSTRIAL USE
19 01	wastes from incineration or pyrolysis of waste
19 01 02	ferrous materials removed from bottom ash
19 01 12	bottom ash and slag other than those mentioned in 19 01 11
19 01 18	pyrolysis wastes other than those mentioned in 19 01 17
19 01 19	sands from fluidised beds
19 02	wastes from physico/chemical treatments of waste (including dechromatation, decyanidation, neutralisation)
19 02 03	premixed wastes composed only of non-hazardous wastes
19 02 10	combustible wastes other than those mentioned in 19 02 08 and 19 02 09
19 04	vitrified waste and wastes from vitrification
19 04 01	vitrified waste
19 05	wastes from aerobic treatment of solid wastes
19 05 01	non-composted fraction of municipal and similar wastes
19 05 02	non-composted fraction of animal and vegetable waste
19 05 03	off-specification compost
19 12	wastes from the mechanical treatment of waste (for example sorting, crushing, compacting, pelletising) not otherwise specified
19 12 01	paper and cardboard
19 12 02	ferrous metal
19 12 03	non-ferrous metal
19 12 04	plastic and rubber
19 12 05	glass
19 12 08	textiles
19 12 09	minerals (for example sand, stones)
19 12 10	combustible waste (refuse derived fuel)
19 13	wastes from soil and groundwater remediation
19 13 02	solid wastes from soil remediation other than those mentioned in 19 13 01

Table S2.1 Permitted waste types and quantities for activity A1 - hazardous and non-hazardous waste for transfer, (excluding WEEE and waste wood transfer and treatment)

Maximum Quantities

The total quantity of all waste accepted at the site shall not exceed 1,000,000 tonnes per year

Waste code	Description
20	MUNICIPAL WASTES (HOUSEHOLD WASTE AND SIMILAR COMMERCIAL, INDUSTRIAL AND INSTITUTIONAL WASTES) INCLUDING SEPARATELY COLLECTED FRACTIONS
20 01	separately collected fractions (except 15 01)
20 01 01	paper and cardboard
20 01 02	glass
20 01 08	biodegradable kitchen and canteen waste
20 01 10	clothes
20 01 11	textiles
20 01 27*	paint, inks, adhesives and resins containing dangerous substances
20 01 28	paint, inks, adhesives and resins other than those mentioned in 20 01 27
20 01 39	plastics
20 01 40	metals
20 01 41	wastes from chimney sweeping
20 02	garden and park wastes (including cemetery waste)
20 02 02	soil and stones
20 03	other municipal wastes
20 03 01	mixed municipal waste
20 03 02	waste from markets
20 03 03	street-cleaning residues
20 03 07	bulky waste

Table S2.2 Permitted Waste types and quantities for activity A2 - Waste Electrical and Electronic Equipment authorised treatment facility

Maximum Quantities

The total quantity of all waste accepted at the site shall be less than 1,000,000 tonnes a year.

Exclusions

Wastes having any of the following characteristics shall not be accepted:

- Consisting solely or mainly of dusts, powders or loose fibres

Waste Code	Description
16	WASTES NOT OTHERWISE SPECIFIED IN THE LIST
16 02	wastes from electrical and electronic equipment
16 02 10*	discarded equipment containing or contaminated by PCBs other than those mentioned in 16 02 09
16 02 11*	discarded equipment containing chlorofluorocarbons, HCFC, HFC – fridges only
16 02 12*	discarded equipment containing free asbestos
16 02 13*	discarded equipment containing hazardous components other than those mentioned in 16 02 09 to 16 02 12

Table S2.2 Permitted Waste types and quantities for activity A2 - Waste Electrical and Electronic Equipment authorised treatment facility

Maximum Quantities

The total quantity of all waste accepted at the site shall be less than 1,000,000 tonnes a year.

Exclusions

Wastes having any of the following characteristics shall not be accepted:

- Consisting solely or mainly of dusts, powders or loose fibres

Waste Code	Description
16 02 14	discarded equipment other than those mentioned in 16 02 09 to 16 02 13
16 02 16	components removed from discarded equipment other than those mentioned in 16 02 15
16 06	batteries and accumulators
16 06 04	alkaline batteries (except 16 06 03)
16 06 05	other batteries and accumulators
20	MUNICIPAL WASTES (HOUSEHOLD WASTE AND SIMILAR COMMERCIAL, INDUSTRIAL AND INSTITUTIONAL WASTES) INCLUDING SEPARATELY COLLECTED FRACTIONS
20 01	separately collected fractions (except 15 01)
20 01 21*	fluorescent tubes and other mercury-containing waste
20 01 23	Discarded equipment containing chloroflourocarbons – fridges only
20 01 33*	batteries and accumulators included in 16 06 01, 16 06 02 or 16 06 03 and unsorted batteries and accumulators containing these batteries
20 01 34	batteries and accumulators other than those mentioned in 20 01 33
20 01 35*	discarded electrical and electronic equipment other than those mentioned in 20 01 21 and 20 01 23 containing hazardous components
20 01 36	discarded electrical and electronic equipment other than those mentioned in 20 01 21, 20 01 23 and 20 01 35

Table S2.3 Permitted Waste types and quantities for activity A3 - wood storage and treatment**Maximum Quantities**

The total quantity of waste all accepted at the site shall be less than 1,000,000 tonnes a year.

Exclusions

Wastes having any of the following characteristics shall not be accepted:

- Consisting solely or mainly of dusts, powders or loose fibres

Waste Code	Description
02	WASTES FROM AGRICULTURE, HORTICULTURE, AQUACULTURE, FORESTRY, HUNTING AND FISHING, FOOD PREPARATION AND PROCESSING
02 01	wastes from agriculture, horticulture, aquaculture, forestry, hunting and fishing
02 01 03	plant – tissue waste
02 01 07	waste from forestry
03	WASTES FROM WOOD PROCESSING AND THE PRODUCTION OF PANELS AND FURNITURE, PULP, PAPER AND PRODUCTION
03 0 1	wastes from wood processing and the production of panels and furniture
03 01 01	waste bark and cork
03 01 05	Sawdust, shavings, cutting, wood, Particle board and veneer other than those mentioned in 03 01 04
15	WASTE PACKAGING; ABSORBENTS, WIPING CLOTHS, FILTER MATERIALS AND PROTECTIVE CLOTHING NOT OTHERWISE SPECIFIED
15 01	packaging (including separately collected municipal packaging waste)
15 01 03	wooden packaging
17	CONSTRUCTION AND DEMOLITION WASTES (INCLUDING EXCAVATED SOIL FROM CONTAMINATED SITES)
17 02	Wood, glass and plastic
17 02 01	wood
17 09	Other construction and demolition waste
17 09 04	Mixed construction and demolition waste other than those mentioned in 17 09 01, 17 09 02 and 17 09 03 wood only
19	WASTES FROM WASTE MANAGEMENT FACILITIES, OFF-SITE WASTE WATER TREATMENT PLANTS AND THE PREPARATION OF WATER INTENDED FOR HUMAN CONSUMPTION AND WATER FOR INDUSTRIAL USE
19 12	wastes from the mechanical treatment of waste (for example sorting, crushing, compacting, pelletising) not otherwise specified
19 12 07	Wood other than that mentioned in 19 12 06
20	MUNICIPAL WASTES (HOUSEHOLD WASTE AND SIMILAR COMMERCIAL, INDUSTRIAL AND INSTITUTIONAL WASTES) INCLUDING SEPARATELY COLLECTED FRACTIONS
20 01	separately collected fractions (except 15 01)
20 01 38	wood other than that mentioned in 20 01 37
20 02	garden and park waste
20 02 01	biodegradable waste – consisting of wood and plant tissue waste only

Schedule 3 – Emissions and monitoring

There are no emission limits or associated emission monitoring requirements.

Schedule 4 – Reporting

There is no reporting under this schedule.

Schedule 5 - Notification

These pages outline the information that the operator must provide.

Units of measurement used in information supplied under Part A and B requirements shall be appropriate to the circumstances of the emission. Where appropriate, a comparison should be made of actual emissions and authorised emission limits.

If any information is considered commercially confidential, it should be separated from non-confidential information, supplied on a separate sheet and accompanied by an application for commercial confidentiality under the provisions of the EP Regulations.

Part A

Permit Number	
Name of operator	
Location of Facility	
Time and date of the detection	

(a) Notification requirements for any malfunction, breakdown or failure of equipment or techniques, accident, or emission of a substance not controlled by an emission limit which has caused, is causing or may cause significant pollution

To be notified within 24 hours of detection
--

Date and time of the event	
Reference or description of the location of the event	
Description of where any release into the environment took place	
Substances(s) potentially released	
Best estimate of the quantity or rate of release of substances	
Measures taken, or intended to be taken, to stop any emission	
Description of the failure or accident.	

(b) Notification requirements for the breach of a limit
--

To be notified within 24 hours of detection unless otherwise specified below

Emission point reference/ source	
Parameter(s)	
Limit	
Measured value and uncertainty	
Date and time of monitoring	
Measures taken, or intended to be taken, to stop the emission	

Time periods for notification following detection of a breach of a limit	
Parameter	Notification period

(c) Notification requirements for the detection of any significant adverse environmental effect	
To be notified within 24 hours of detection	
Description of where the effect on the environment was detected	
Substances(s) detected	
Concentrations of substances detected	
Date of monitoring/sampling	

Part B - to be submitted as soon as practicable

Any more accurate information on the matters for notification under Part A.	
Measures taken, or intended to be taken, to prevent a recurrence of the incident	
Measures taken, or intended to be taken, to rectify, limit or prevent any pollution of the environment which has been or may be caused by the emission	
The dates of any unauthorised emissions from the facility in the preceding 24 months.	

Name*	
Post	
Signature	
Date	

* authorised to sign on behalf of the operator

Schedule 6 - Interpretation

“*accident*” means an accident that may result in pollution.

“*Annex I*” means Annex I to Directive 2008/98/EC of the European Parliament and of the Council on waste.

“*Annex II*” means Annex II to Directive 2008/98/EC of the European Parliament and of the Council on waste.

“*application*” means the application for this permit, together with any additional information supplied by the operator as part of the application and any response to a notice served under Schedule 5 to the EP Regulations.

“*authorised officer*” means any person authorised by the Environment Agency under section 108(1) of The Environment Act 1995 to exercise, in accordance with the terms of any such authorisation, any power specified in section 108(4) of that Act.

“*best available treatment, recovery and recycling techniques*” shall have the meaning given to it in the document published jointly by the Department for Environment, Food and Rural Affairs, the Welsh Assembly Government and the Scottish Executive on 27th November 2006, entitled “Guidance on Best Available Treatment, Recovery and Recycling Techniques (BATRRRT) and Treatment of Waste Electrical and Electronic Equipment (WEEE);

“*building*” means a construction that has the objective of providing sheltering cover and minimising emissions of noise, particulate matter, odour and litter.

“*controlled substances*” means *chlorofluorocarbons, other fully halogenated chlorofluorocarbons, halons, carbon tetrachloride, 1,1,1-trichloroethane, methyl bromide, hydrobromofluorocarbons and hydrochlorofluorocarbons listed in Annex I of Regulation (EC) No 2037/2000 of the European Parliament and of the Council of 29 June 2000 on substances that deplete the ozone layer, including their isomers, whether alone or in a mixture, and whether they are virgin, recovered, recycled or reclaimed. This definition shall not cover any controlled substance which is in a manufactured product other than a container used for the transportation or storage of that substance, or insignificant quantities of any controlled substance, originating from inadvertent or coincidental production during a manufacturing process, from unreacted feedstock, or from use as a processing agent which is present in chemical substances as trace impurities, or that is emitted during product manufacture or handling.*

“*D*” means a disposal operation provided for in Annex I to Directive 2008/98/EC of the European Parliament and of the Council on waste.

“*emissions to land*” includes emissions to groundwater.

“*EP Regulations*” means The Environmental Permitting (England and Wales) Regulations SI 2010 No.675 and words and expressions used in this permit which are also used in the Regulations have the same meanings as in those Regulations.

“*emissions of substances not controlled by emission limits*” means emissions of substances to air, water or land from the activities, either from the emission points specified in schedule 3 or from other localised or diffuse sources, which are not controlled by an emission or background concentration limit..

“*groundwater*” means all water, which is below the surface of the ground in the saturation zone and in direct contact with the ground or subsoil.

“*hazardous waste*” has the meaning given in the Hazardous Waste (England and Wales) Regulations 2005 No.894, the Hazardous Waste (Wales) Regulations 2005 No. 1806 (W.138), the List of Wastes

(England) Regulations 2005 No.895 and the List of Wastes (Wales) Regulations 2005 No. 1820 (W.148).

“impermeable surface” means a surface or pavement constructed and maintained to a standard sufficient to prevent the transmission of liquids beyond the pavement surface, and should be read in conjunction with the term *“sealed drainage system”* (below).

“ozone-depleting substances” *“ODS”* means *“controlled substances”* contained in refrigeration, air-conditioning and heat pump equipment, equipment containing solvents, fire protection systems and fire extinguishers.

“Pests” means Birds, Vermin and Insects.

“R” means a recovery operation provided for in Annex II to Directive 2008/98/EC of the European Parliament and of the Council on waste.

“specified waste” means the following waste codes in Table S2.1: 01 01 01, 01 01 02, 01 04 08, 01 04 09, 01 04 13, 02 04 01, 10 11 12, 10 12 08, 10 13 14, 15 01 07, 17 01 01, 17 01 02, 17 01 03, 17 01 07, 17 02 02, 17 03 02, 17 05 04, 17 05 08, 19 12 05, 19 12 09 and 20 02 02.

“sealed drainage system” in relation to an impermeable surface, means a drainage system with impermeable components which does not leak and which will ensure that:

- (a) no liquid will run off the surface otherwise than via the system;
- (b) except where they may lawfully be discharged to foul sewer, all liquids entering the system are collected in a sealed sump.

“Waste code” means the six digit code referable to a type of waste in accordance with the List of Wastes (England) Regulations 2005, or List of Wastes (Wales) Regulations 2005, as appropriate, and in relation to hazardous waste, includes the asterisk.

“Waste Framework Directive” or *“WFD”* means Waste Framework Directive 2008/98/EC of the European Parliament and of the Council on waste.

“WEEE” means waste electrical and electronic equipment.

“WEEE Directive” means Directive 2002/96/EC of the European Parliament and of the Council of 27th January 2003 on waste electrical and electronic equipment (WEEE) as amended by Directive 2012/19/EU of the European Parliament and of the Council of 8th December 2003 on waste electrical and electronic equipment (WEEE).

“year” means calendar year ending 31 December

Schedule 7 - Site Plan

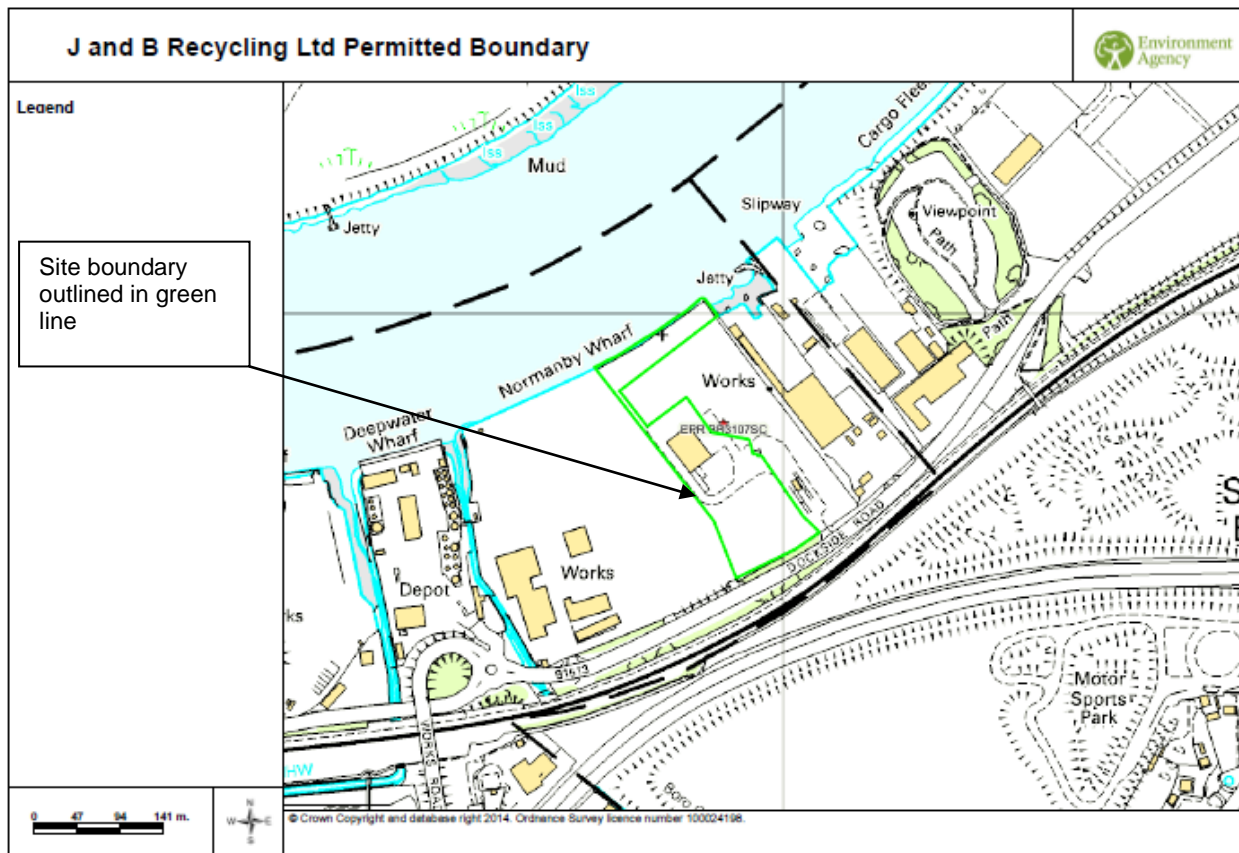

END OF PERMIT